

Home + Project

MyHOME system configuration app

General features and new functions

October 2024



bticino



A tool just for you.

The Home + Project application, developed by BTicino, is a dedicated working tool for installers, which they can use to design and configure MyHOME home automation systems on site using iOS and Android smartphones or tablets.

This document explains the new functions introduced to make it even easier and more intuitive to use.

Home + Project main features:

- **Tool for the configuration** and testing of all system devices;
- **Copy and Paste** function to replicate projects and save time;
- **Share projects** with colleagues;
- **Archiving of all projects** for future use or maintenance.

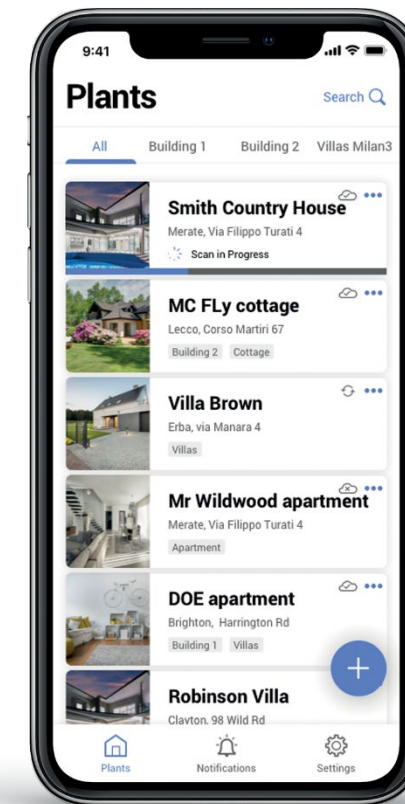
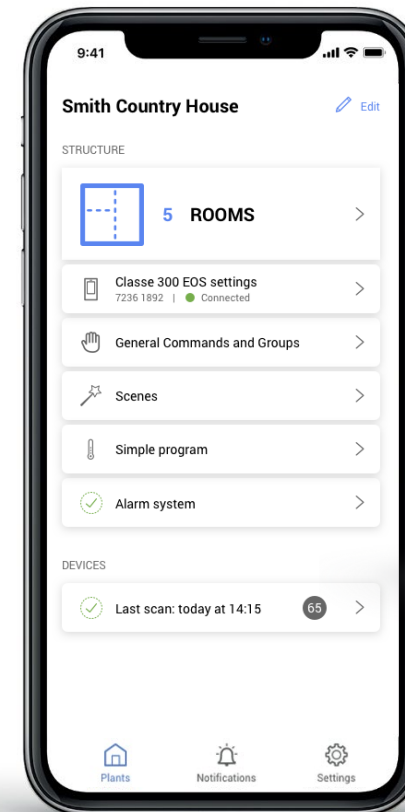



Requirements for using Home + Project

A server, selected according to the type of system, must be installed in the MyHOME system:

- Item **F460** or **MyHomeserver1** with updated firmware (version 2.32.9 or later): MyHOME servers for DIN switchboards that enables remote configuration and management of the system. Choose it **in case of new installations without video door entry function or where it is used with a HOMETOUCH touch screen.**
- **Classe 300EOS with Netatmo**: the first video internal unit with built-in Alexa assistant that also functions as a server for the MyHome system. Choose it **in the case of new installations where the integration of the video door entry system is also required:** easy, flexible and savings!



Classe 300EOS
with Netatmo

DIN Server F460

New features just for you

The following table shows the Home+Project features added in recent months; **those introduced in October** are highlighted in **orange**. Please remember that for their use it is necessary that the server firmware version and the respective app version comply with the indications given in the table.

	MyHomeserver1 firmware version	Home + Project app version	Classe 300EOS firmware version	Home + Project app version	Page
1. Configuration backup and restore	3.83.3	1.0.37	2.5.5	1.0.37	5
2. System function test	3.82.10	1.0.35	2.4.8	1.0.35	6
3. Exporting of device addresses	----	1.0.35	----	1.0.35	7
4. System configuration even when the Internet is not available	----	1.0.21	----	1.0.23	8
5. Firmware update from Home+Project	3.71.11	1.0.20	2.2.11	1.0.23	9
6. "Identify" test for the recognition of the loads	3.71.31	1.0.24	2.2.16	1.0.24	10
7. Calibration of the temperature probe	2/3.81.x	1.0.32	----	----	11
8. Association of several control devices with one actuator	----	1.0.40	----	1.0.40	12
9. Automatic association of controls with actuators	----	1.0.40	----	1.0.40	13
10. Even more stable connection to the system	----	1.0.40	----	1.0.40	14
11. Compatibility with Tablet devices	----	1.0.41	----	1.0.41	15
12. Replacement of a device without reconfiguring the system	----	1.0.42	----	1.0.42	16
13. Configuration of control and energy display devices	----	----	3.0.5	----	17
14. Addition of a pop-up for app evaluation	----	1.0.45	----	1.0.45	18
15. Quick identification of a device to change its configuration	----	1.0.45	----	1.0.45	19



1. Configuration backup and restore

The system backup and restore function allows to replace the system server without having to completely restore the configuration of all devices.

All data on rooms, objects, groups, scenarios and gateway settings configured with Home + Project will be automatically transferred to the new server.

Note: backup only possible for systems configured with Home + Project. For the other systems, it will be necessary to first carry out the configuration with the application and then proceed with the respective backup.

Customisations made by the user, such as temperature programming, new scenarios, smart notifications and scheduled automations will not be saved in the backup.

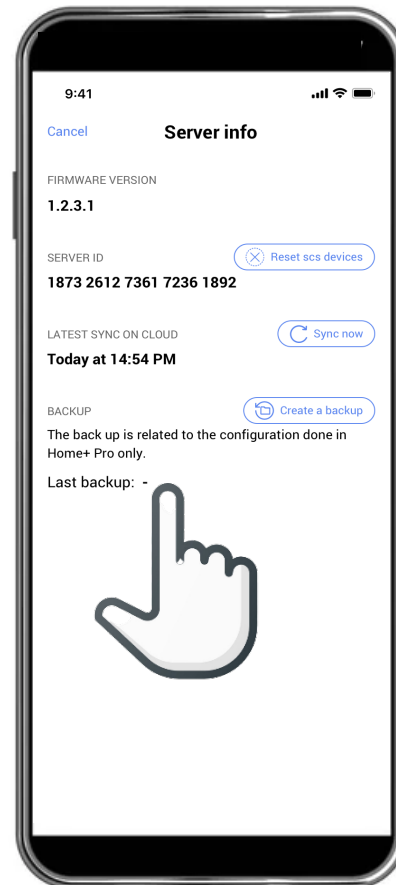

Info screen for system without configuration backup

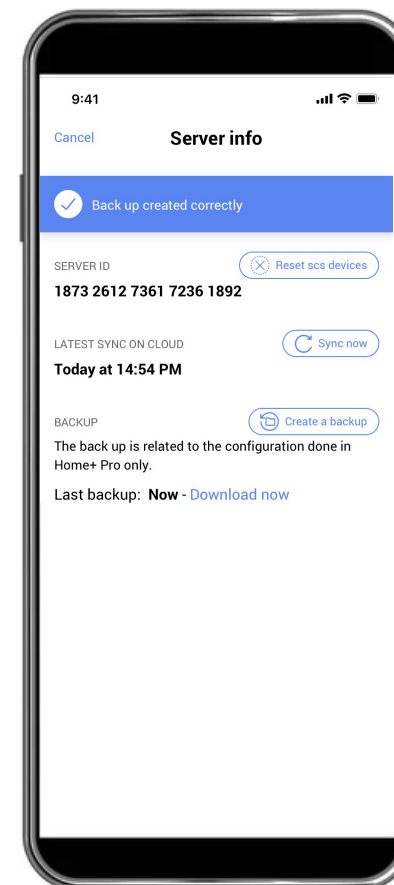

Backup file creation confirmation message

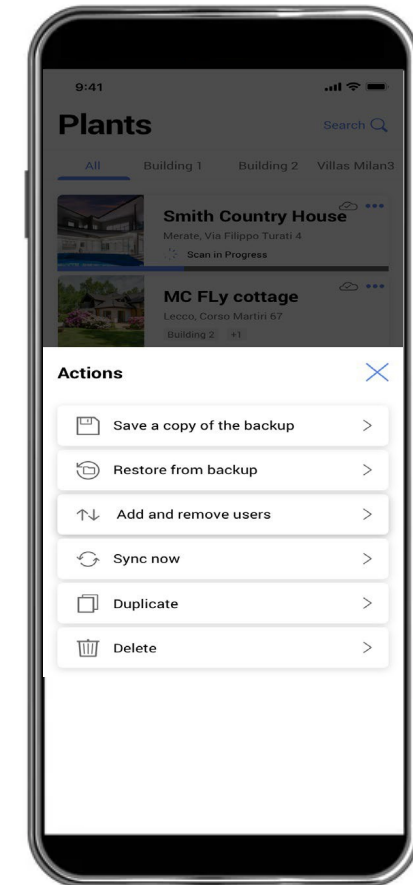

Menu for choosing the functions available with the backup file



2. System function test

After completing the configuration of the system, Home + Project can be used to test the system, without the need for other tools or the Home+Control application intended for your customer.

During the test, it will be possible to check that each device has been configured and is working correctly. Any configuration errors will be highlighted, so that they can be resolved.

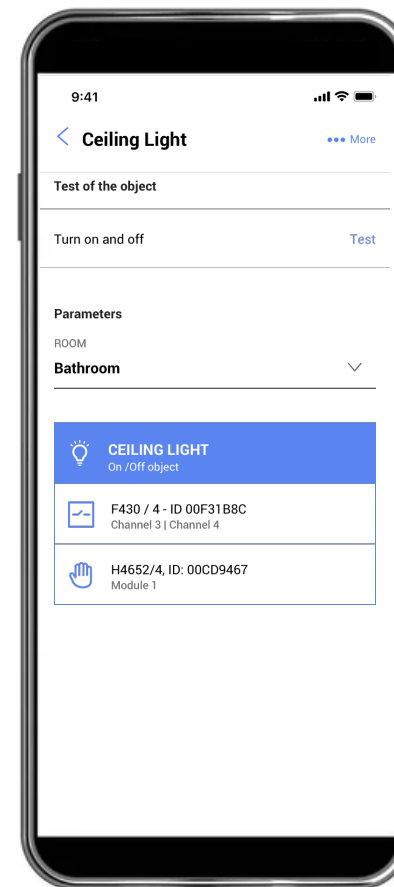

Light actuator test

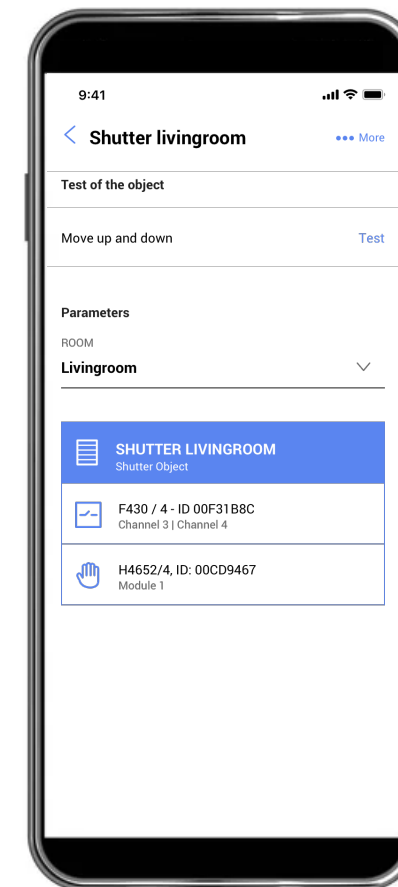

Shutter actuator test



3. Exporting of device addresses

In special situations, such as the configuration of advanced applications via Driver Manager F459 or the definition of complex scenarios, the export of certain configuration details of the SCS addresses of the devices in the system may be required.

This operation is now possible using the Home + Project app, which allows all SCS addresses of configured devices updated at the last connection to the system to be exported to a file.

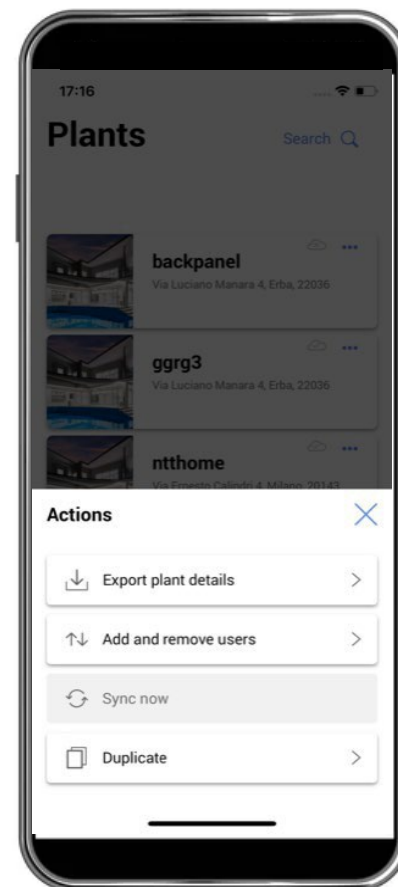

Address exporting menu

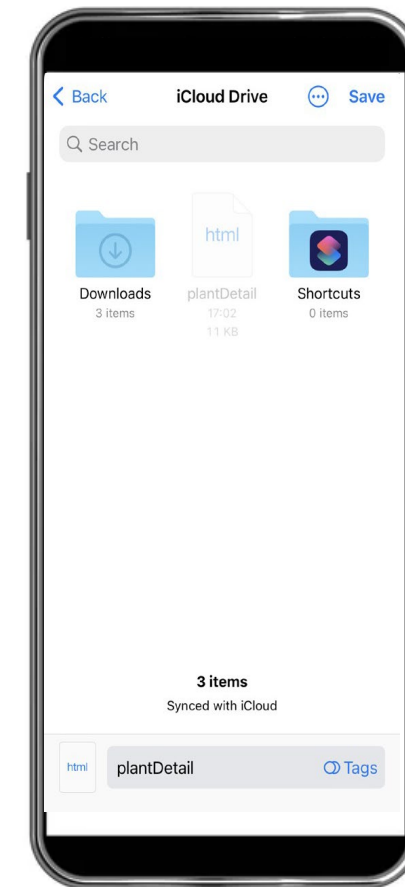
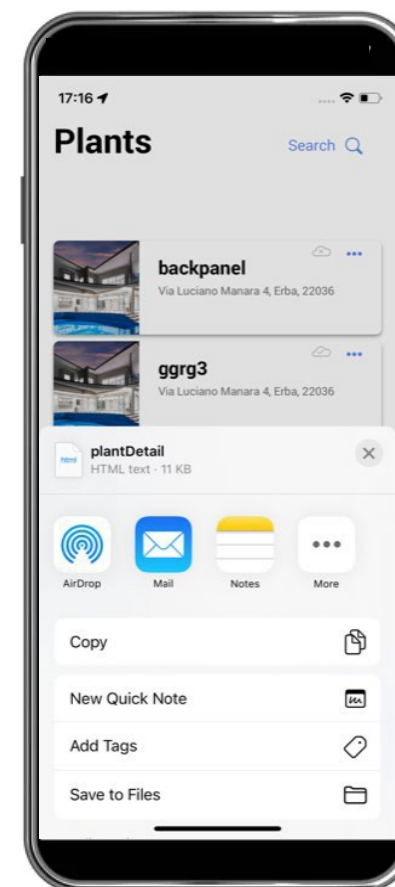

Storage folder in the Legrand Cloud



4. System configuration even when the Internet is not available

Thanks to the “local” connection of the Smartphone with the web server, it is now possible to configure a new MyHOME system on site even if the Internet network is not available.

When the Internet network then becomes available, all configuration data stored in the Smartphone will be transferred to the Legrand Cloud for archiving.

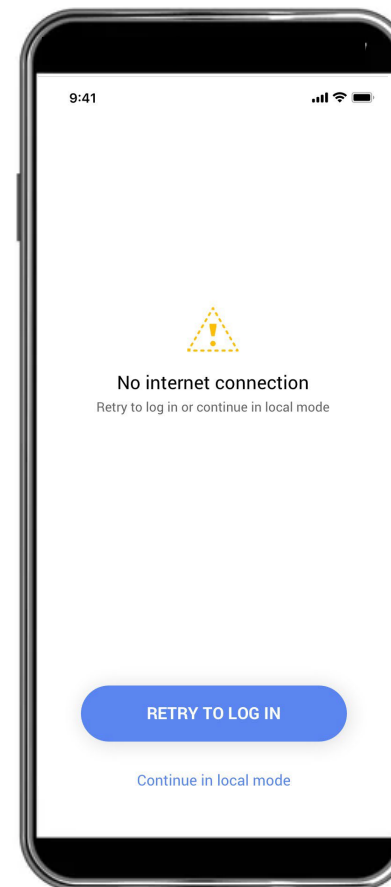

Internet not available notification

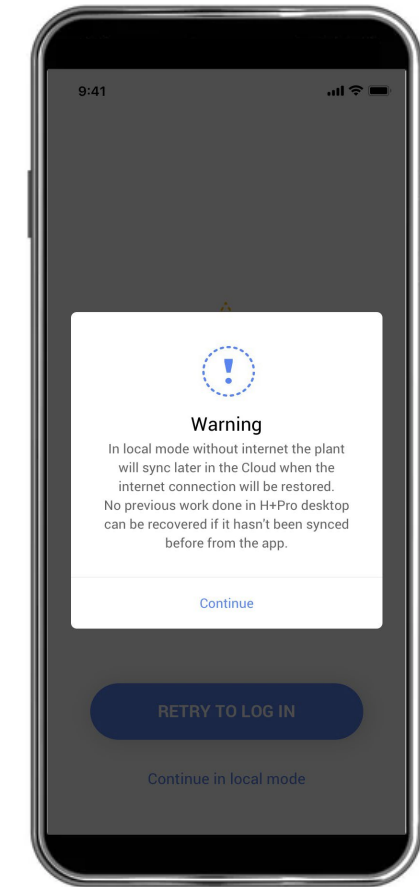
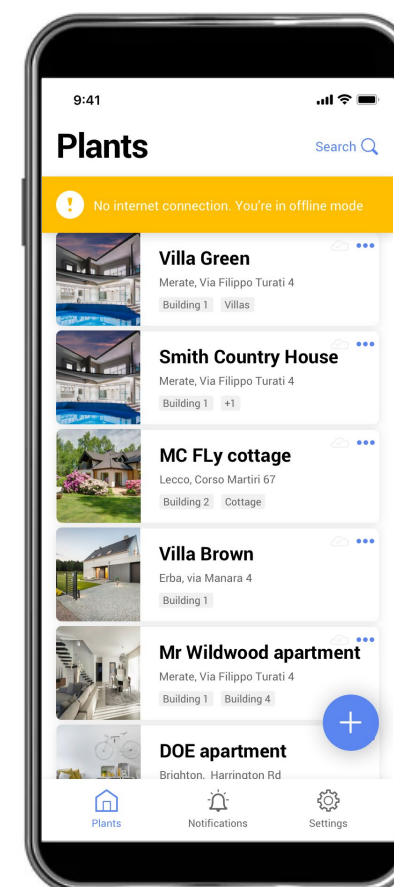

Request of confirmation to complete the configuration off-line



5. Firmware update from Home + Project

The availability of new firmware is notified by a “popup” message in the application, through which it will be possible to update the web server in two steps:

1. Downloading the firmware to the Smartphone from the Legrand Cloud.
2. Uploading the firmware to the web server; this can also be done in the absence of the Internet network.

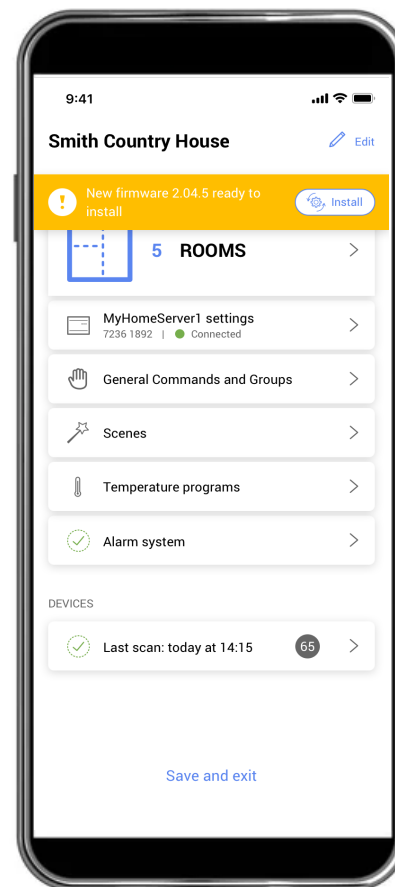

Notification of new firmware availability

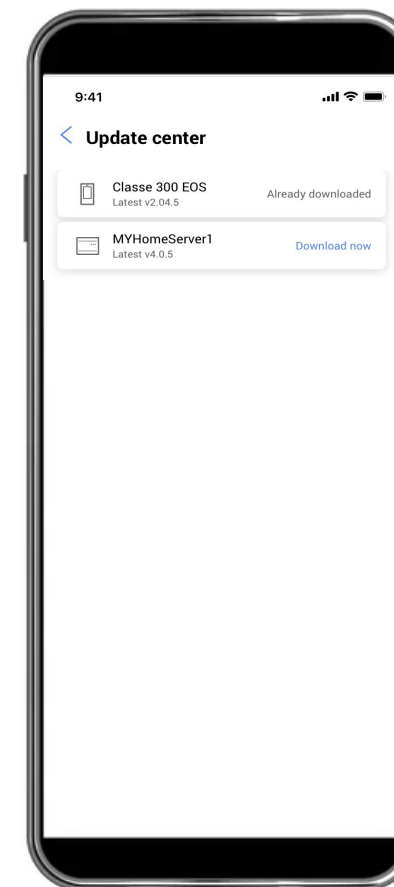
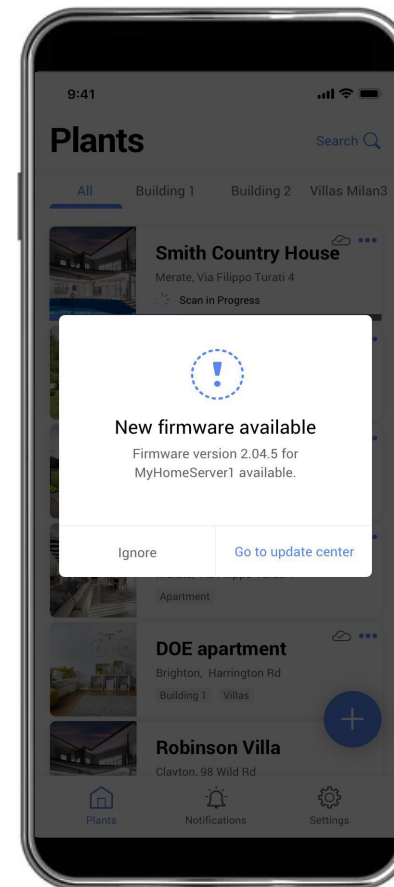

Download of the new firmware

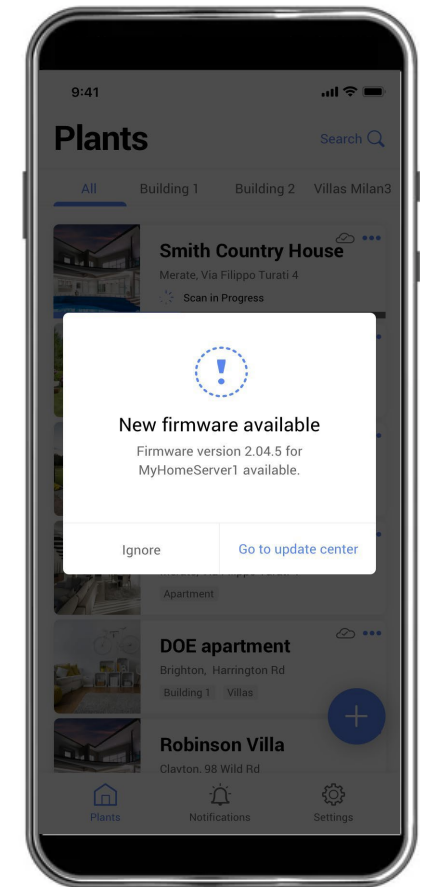

Installation of the new firmware

6. “Identify” test for the recognition of the loads

During the system configuration, with this function the installer will be able to configure an actuator that may not be easily accessible.

Thanks to the “Identify Test” in the system, the loads connected to the actuators are activated in sequence, allowing, for each actuator, the identification of the channel number to be associated with the respective control device and graphic icon.

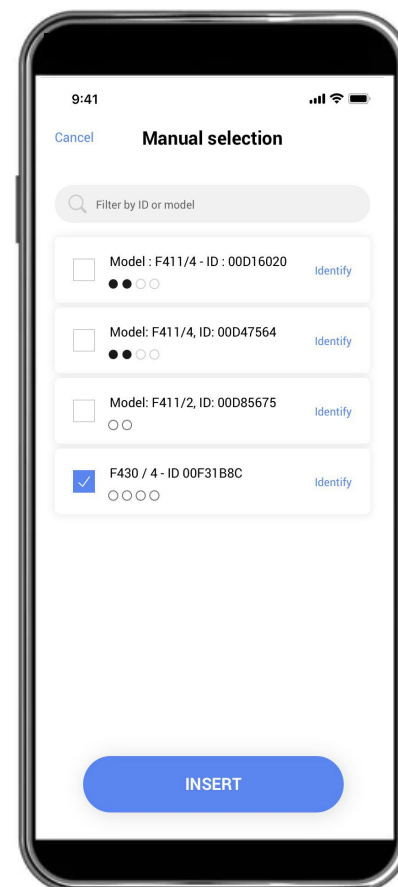

Actuator definition

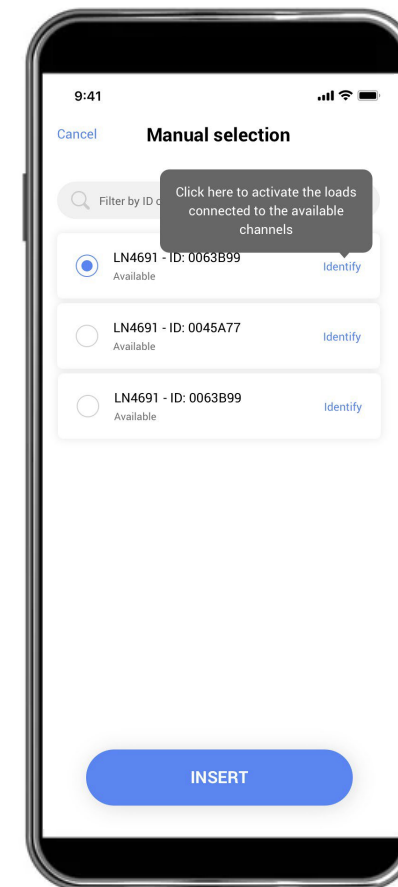
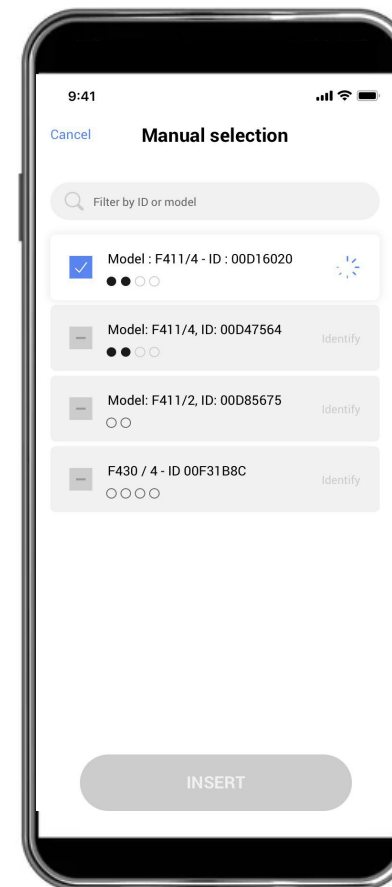

Association of the control device



7. Calibration of the temperature probe

If the MyHOME thermostat is installed near a window or a hot water pipe, the measured temperature may differ from the actual temperature. This could cause unexpected behaviour in the temperature control system.

To solve this issue, Home + Project offers a special calibration function to be used during installation, with the object of directly setting the measured temperature.

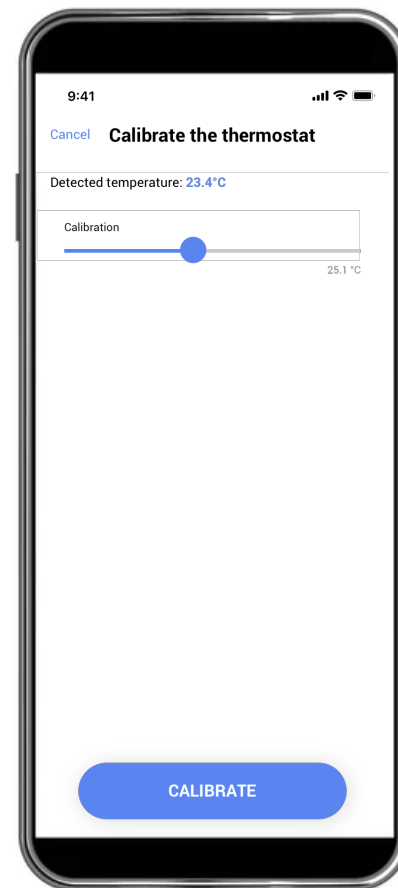

Temperature calibration



The function is compatible with Living Now temperature probes

8. Association of several control devices with one actuator

This new function allows, with one operation, to associate several control devices with a single actuator (light or shutter).

This will simplify and speed up the putting into service of the system, as there will be no need to repeat the pairing procedure for each control device with the same actuator, if required.

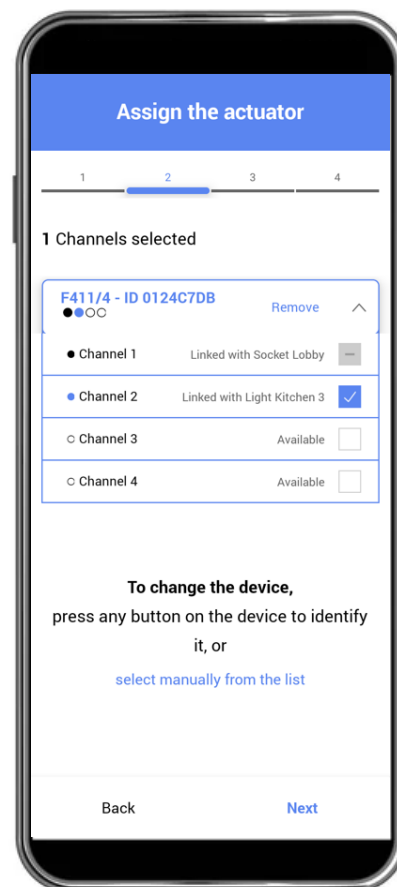

Actuator and channel selection

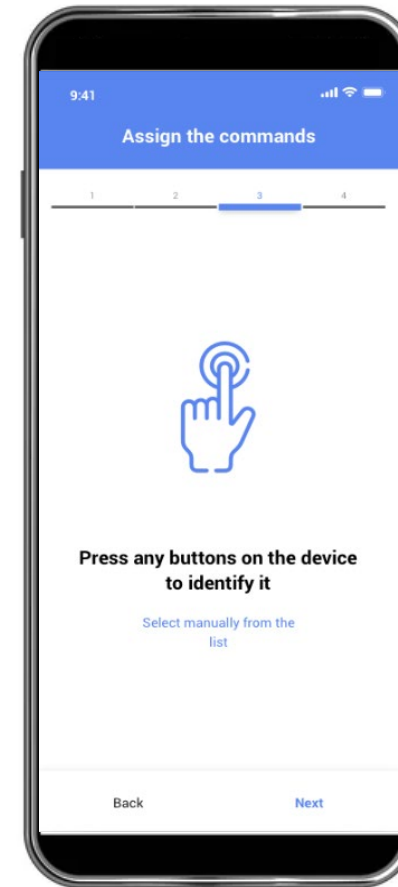

Definition of the first control device to be associated

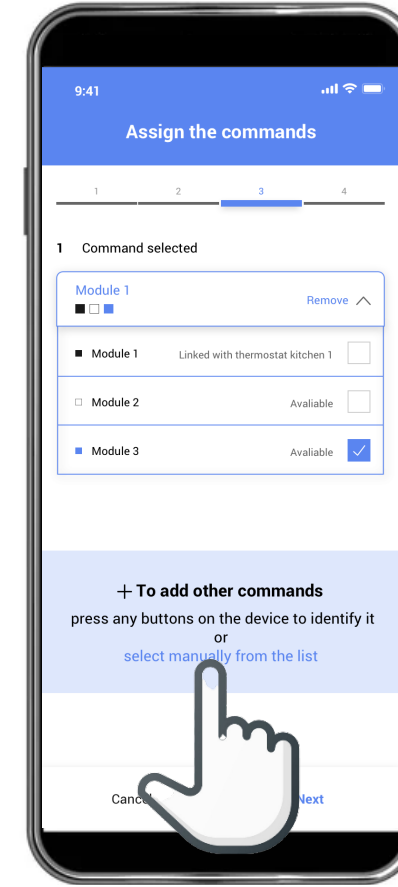

Setting of the parameters and selection for the addition of the second control device

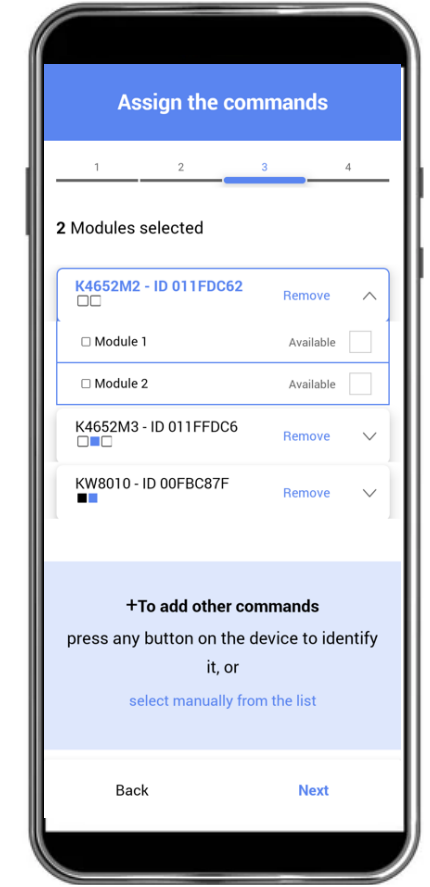

Setting of the parameters of the second control device to be associated

9. Automatic association of controls with actuators

With this new function, after selecting an actuator to be configured, Home + Project will automatically suggest the respective control device to be associated. This will allow to reduce the time for putting into operation the system by eliminating possible configuration errors. However, it will still be possible to select a different control device, if preferred.

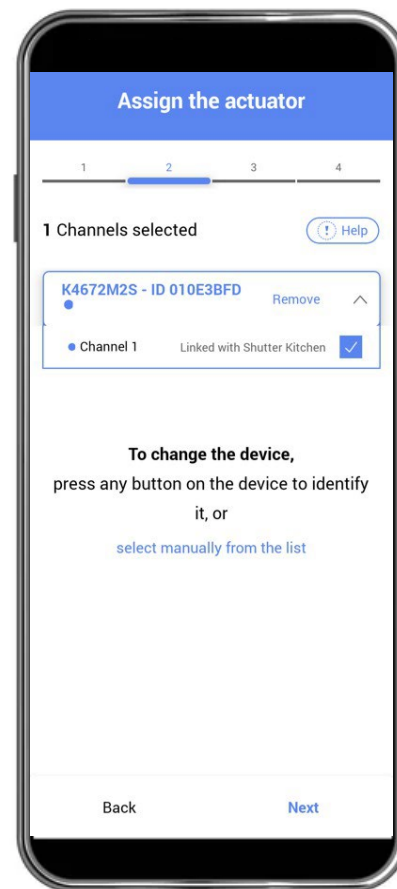

Actuator selection; in the example, item no. K4672M2S for rolling shutters

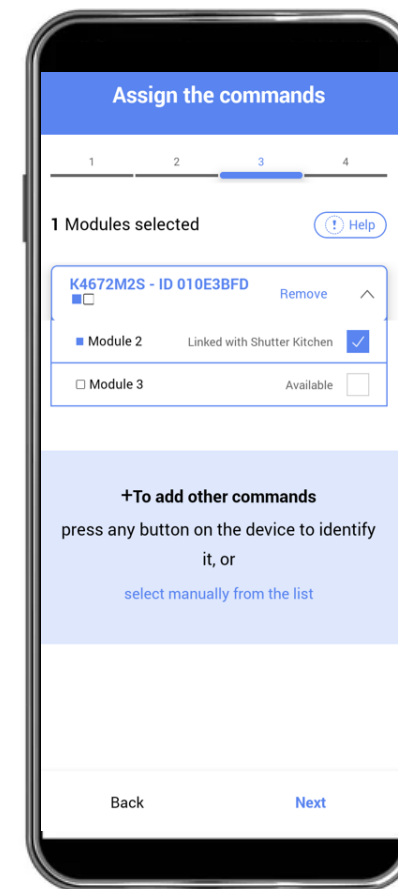

Home+Control suggest the association with the control on the actuator itself



If you want to associate another control device, remove the selection made by Home+Control



10. Even more stable connection to the system

In addition to the introduction of new functions, Home + Project has been improved to make the system configuration safer and more reliable.

The occasional interruption or disconnection of the app from the system when the smartphone receives a phone call or a message, starts another app or accidentally crashes, will no longer occur.

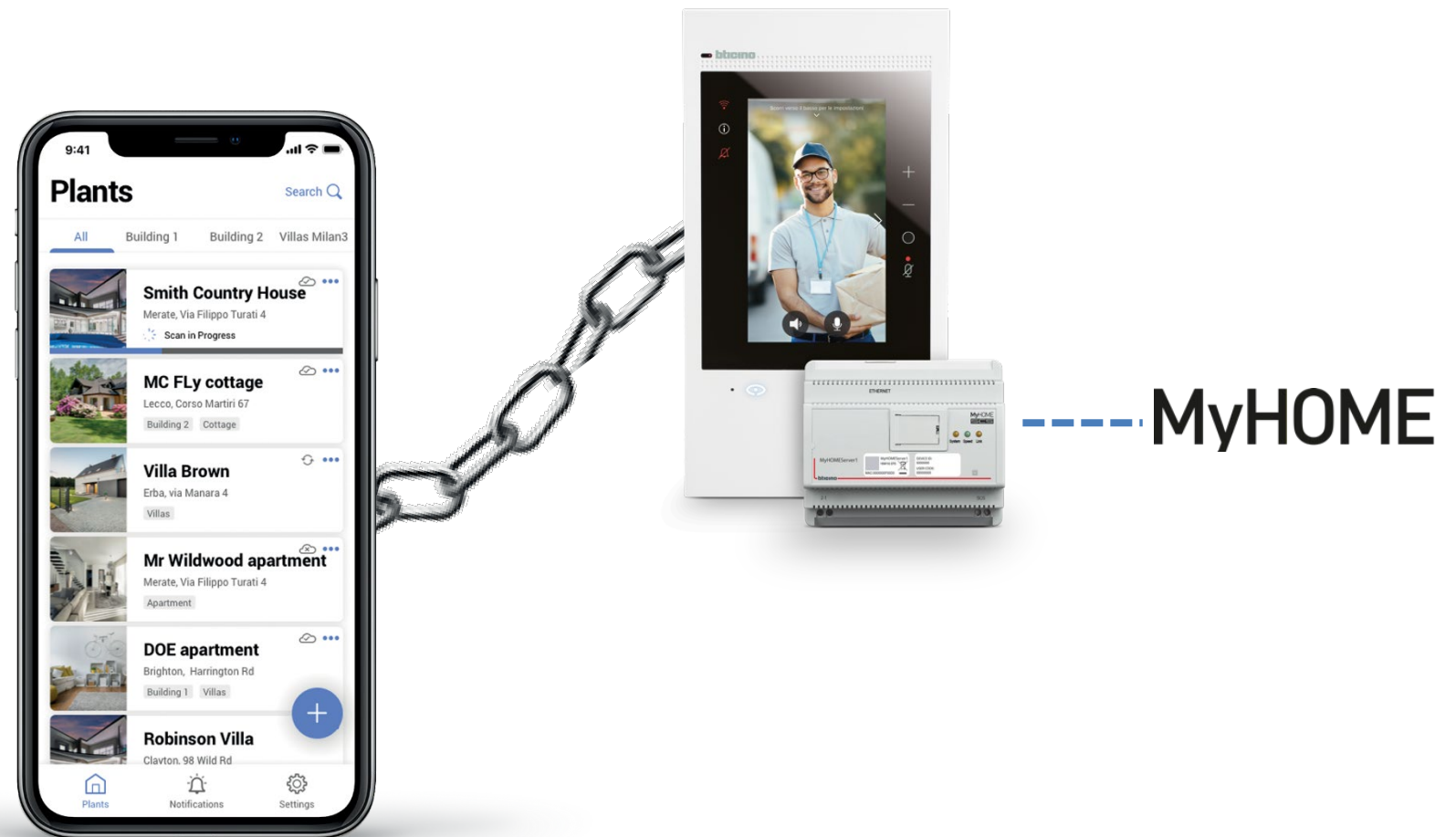



11. Compatibility with Tablet devices

If you are already using an iOS or Android Tablet for your work, you can also use it to configure MyHOME.

Home + Project is officially compatible with this device, which, thanks to its large screen, offers a more comfortable user experience.

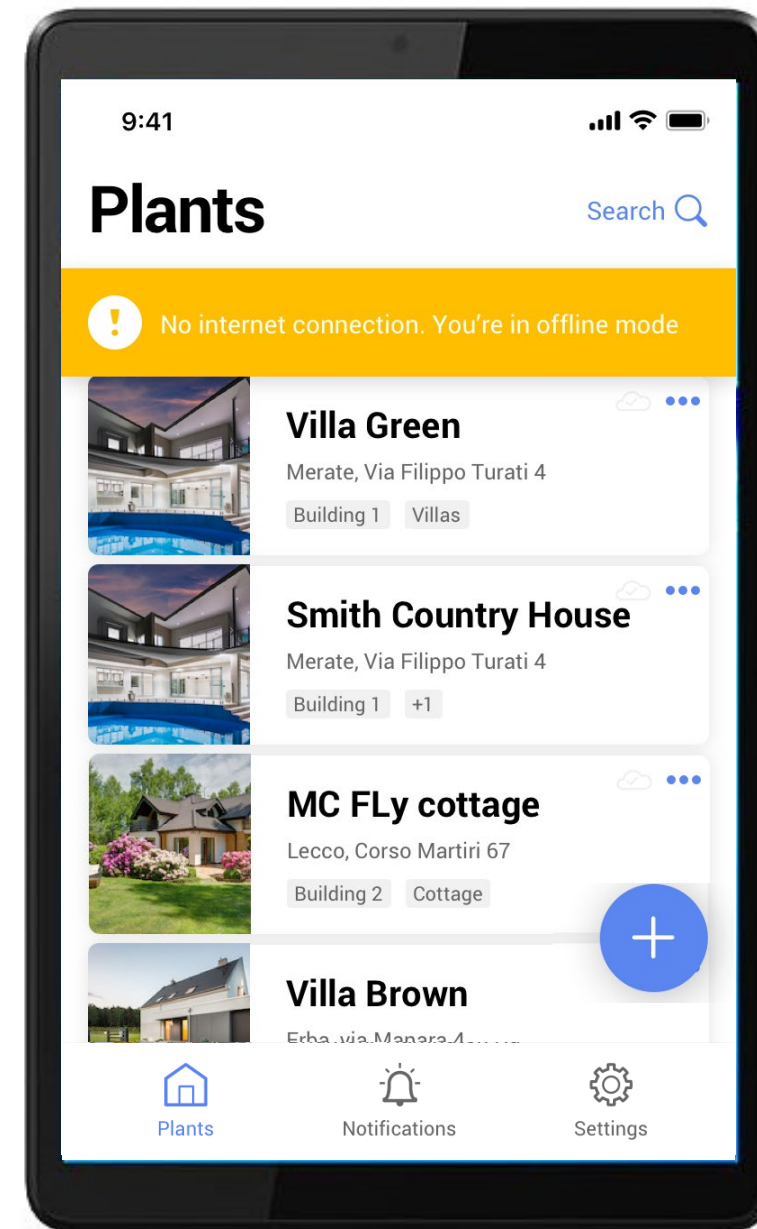



12. Replacement of a device without reconfiguring the system.

With this function, replacing a device in the system for maintenance does not require reconfiguring all other devices. Depending on the model, the new device inherits the complete configuration of the previous one, including scenarios, groups, and temperature control profiles. The function is guaranteed only if the replacement device has the same article code.

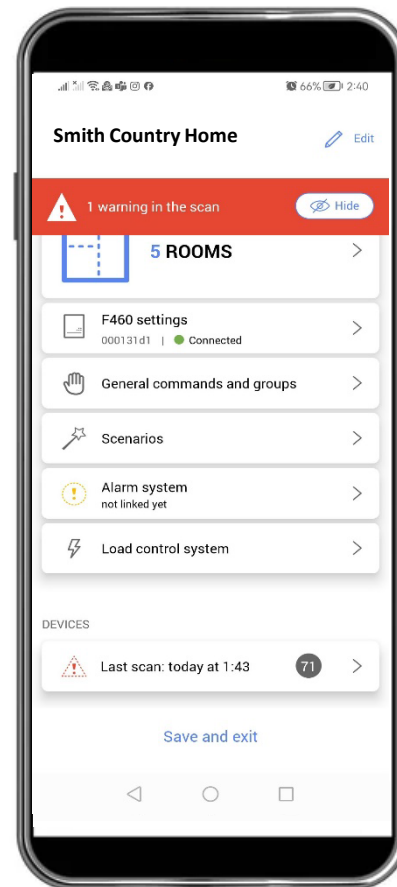

Notification of the presence of the new unconfigured device in the system

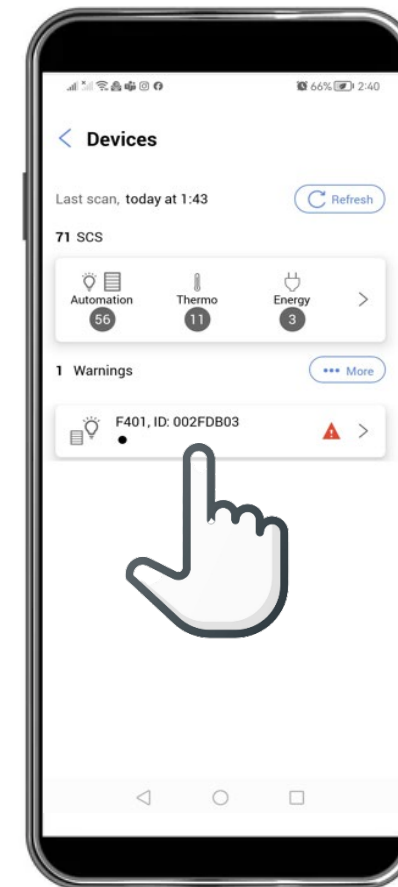

Home+Control shows the new device to be configured

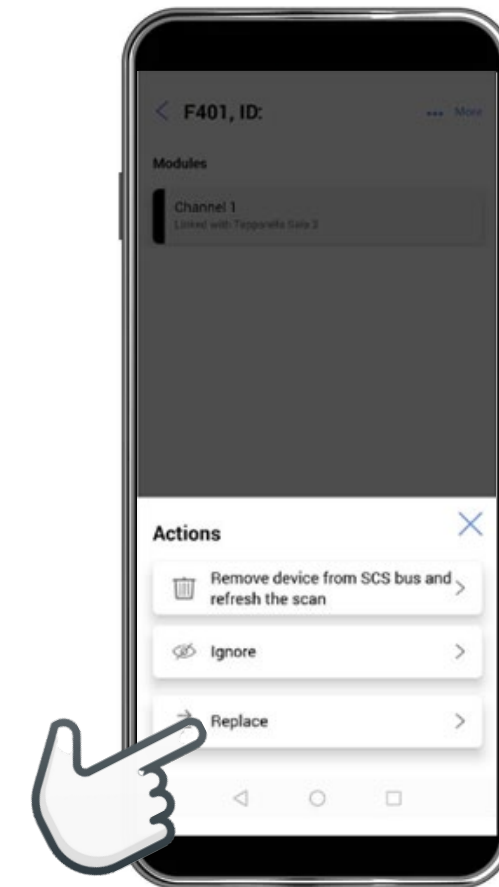

By choosing 'Replace' the procedure for transferring the configuration to the new device is initiated



13. Configuration of control and energy display devices

Using the Classe 300EOS with Netatmo internal unit with firmware version 3.0.5 or later as the SCS server, the installer can configure MyHOME devices of the Load Control system (F521 central unit, F522 and F523 actuators) and Consumption Visualization (F520 energy meter) using the Home + Project app, instead of physical configuration or the MyHOME_Suite software.

With Home + Project, it will be possible to define new and advanced functions, such as activating scenarios or automations in the system based on the values of produced or consumed energy measured on a line or related to a specific load.

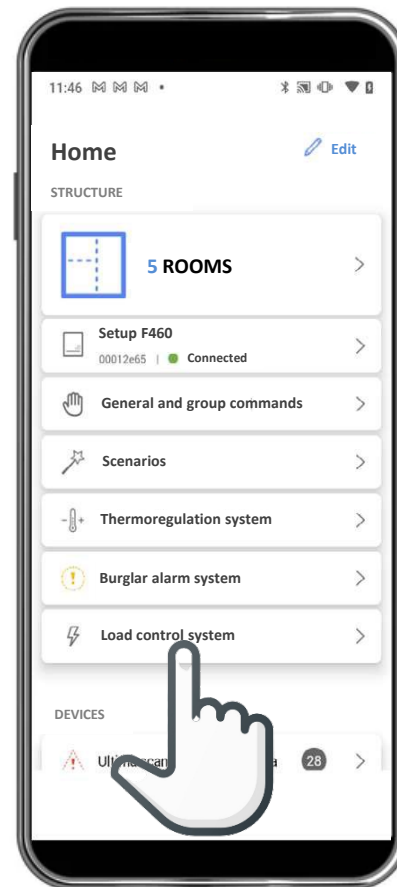

Esempio di configurazione del sistema controllo carichi.
1. Selezione del sistema.

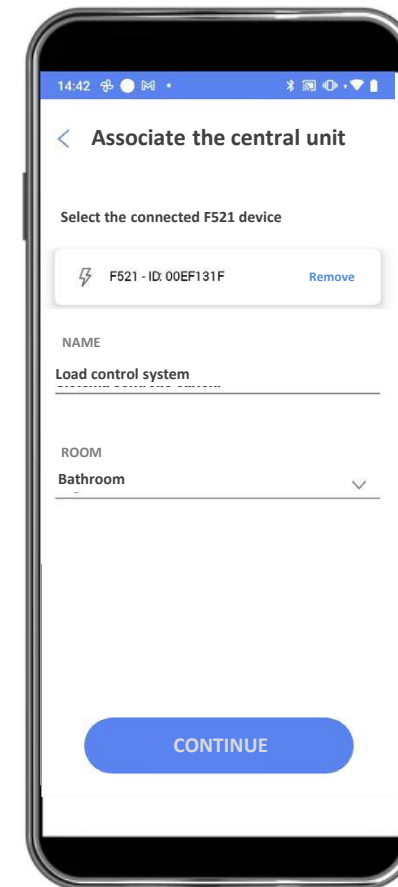

2. Selection of the F521 central unit.

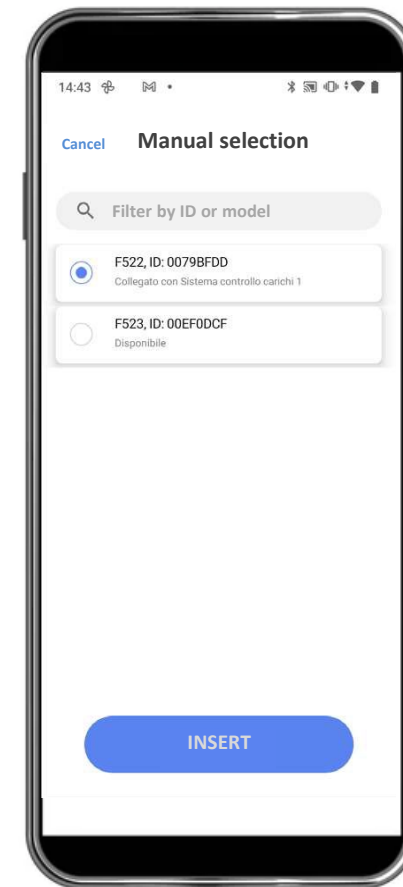

3. Selection of the F522 actuator to be associated with the control unit.

Home + Project **New**

14. Addition of a pop-up for app evaluation

To continuously improve services and products, BTicino has introduced a pop-up in the app to gather feedback on the satisfaction level of installers or to collect reports of any issues. After 21 days from the app installation or after an update, the pop-up will invite the installer to rate the app. If the rating is 3 stars or higher, the installer will be directed to the official Apple or Android store to post the review. In case of a lower rating, they will be prompted to report issues or suggestions for improvement before being redirected to the stores.

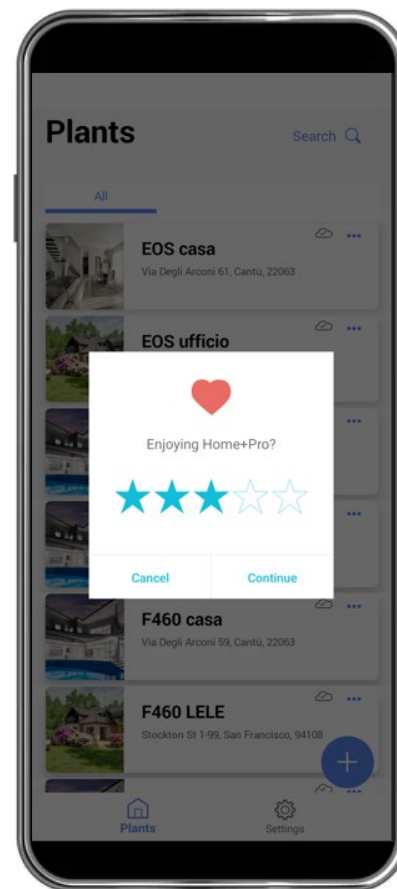

Pop-up to specify the level of satisfaction

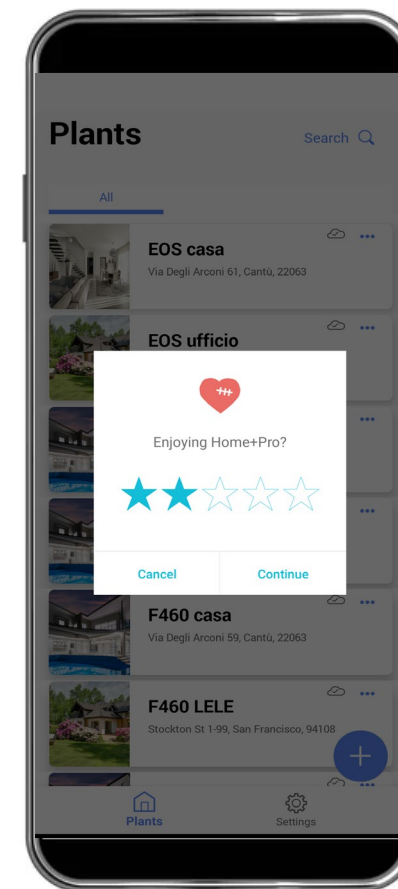

If you don't particularly like the app.....

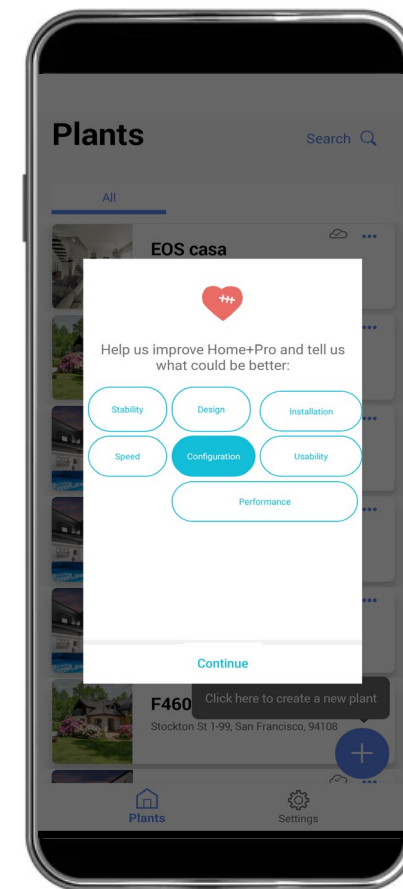

.... you will be invited to specify the area of improvement.

15. Quick identification of a device to change its configuration

The identification of devices in the system for configuration changes are now speeded up through a new procedure. By simply pressing on the device concerned, the app will show its current configuration and all the information relating to any scenarios, general commands, group commands in which the device is included. At this point, the installer will be able to modify the configuration parameters to enable the device for new functions.

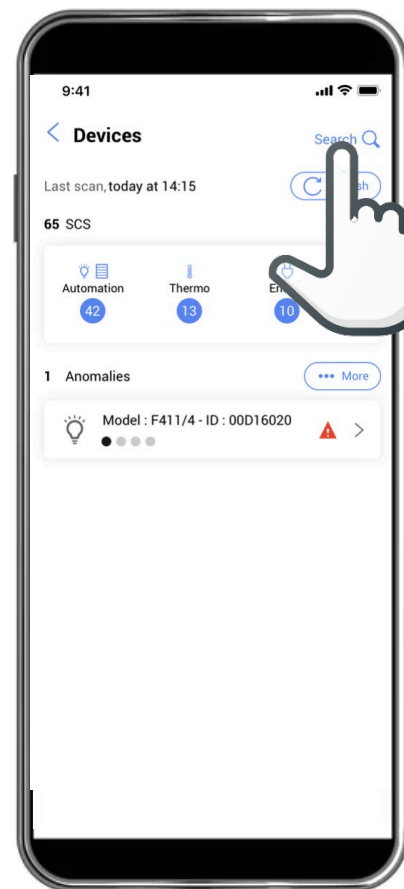

Startup screen of the identification of the device.

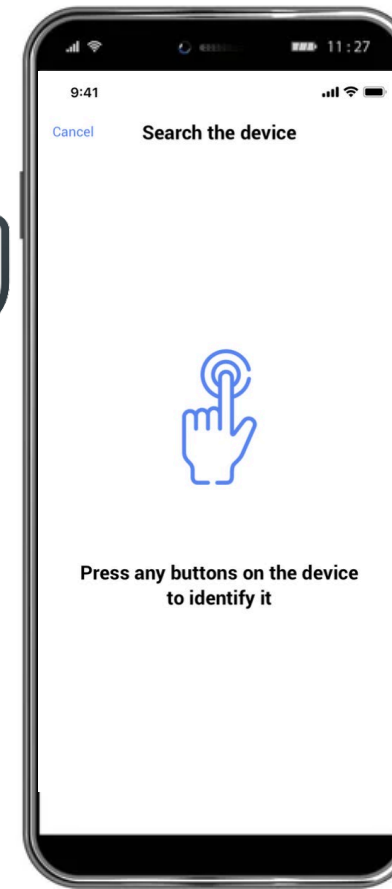

Press the device key to identify it.

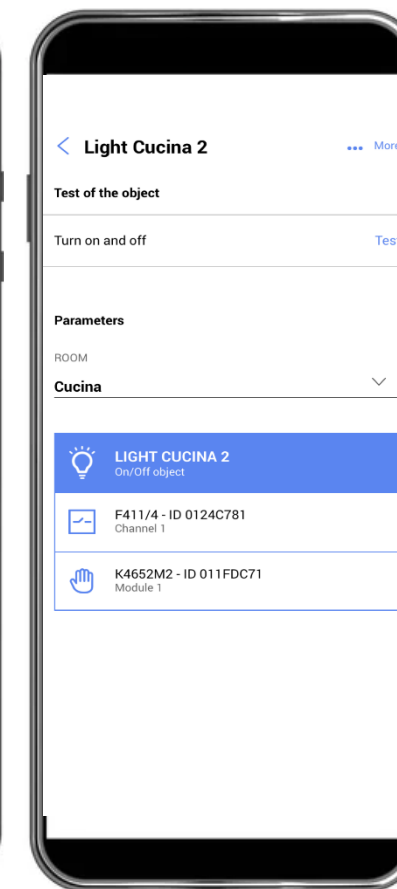

The app provides configuration information and the type of associated actuator.

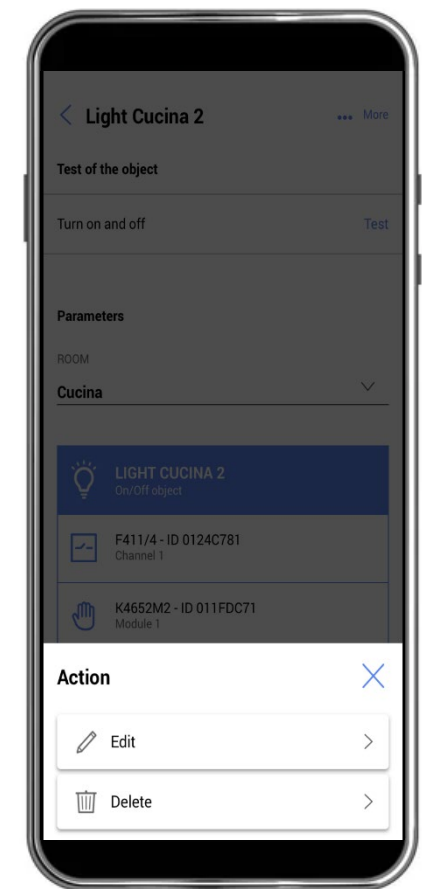

By selecting «other» you can modify or delete the current configuration.

bticino